

Deep groove ball bearings - Single-row - Open type

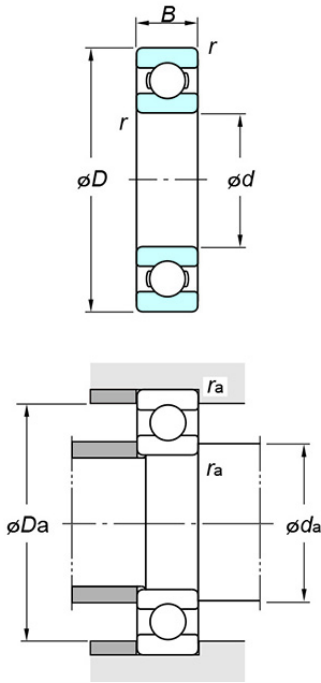

Bearing No. 6014

Specifications

(Boundary dimensions ...etc)

d(mm)	70
D(mm)	110
B(mm)	20
r(min.)(mm)	1.1
Basic load ratings : Cr(kN)	47.6
Basic load ratings : C0r(kN)	30.9
Fatigue load limit : Cu(kN)	1.80
factor : f0(l)	15.6
Limiting speeds(Grease lub.)(min-1)	6100
Limiting speeds(Oil lub.)(min-1)	7200

Mounting dimensions

da(min.)(mm)	76.5
Da(max.)(mm)	103.5
ra(max.)(mm)	1

Refer.

(Refer.)Mass(kg)	0.602
------------------	-------